

# ATLAS ROOMS

**Description:** Flexible conference and event facility with retractable walls that can be converted into different size rooms. Total of six conference rooms that can be partitioned into two large rooms or four conference rooms.

**Specials:** Adjacent to and on the same floor as the Aurora Ballroom. Retractable screen projector screen, air conditioning.

## Fully extended

**Area:** 123 m<sup>2</sup>  
**Length:** 16 m  
**Width:** 7.7 m  
**Height:** 2.6 m

## Central partition

**Area:** 59 – 63 m<sup>2</sup>  
**Length:** 7.7 – 8.1 m  
**Width:** 7.7 m  
**Height:** 2.6 m

## Partitioned into 6 separate rooms

**Area:** 37 - 43 m<sup>2</sup>  
**Length:** 4.8 – 5.7 m  
**Width:** 7.7 m  
**Height:** 2.6 m

**Lights:** Integrated ceiling lights with dimmer, feature wall lighting with colour settings.

**Daylight:** Feature marine windows with curtains or black out blinds

Set-ups:	Maximum capacity		
	Fully extended	Central partition	Separate rooms
<b>Theatre:</b>	100	50	30
<b>Class room:</b>	80	50	20
<b>U-shape:</b>	40	32	20
<b>Boardroom:</b>	48	24	10/16

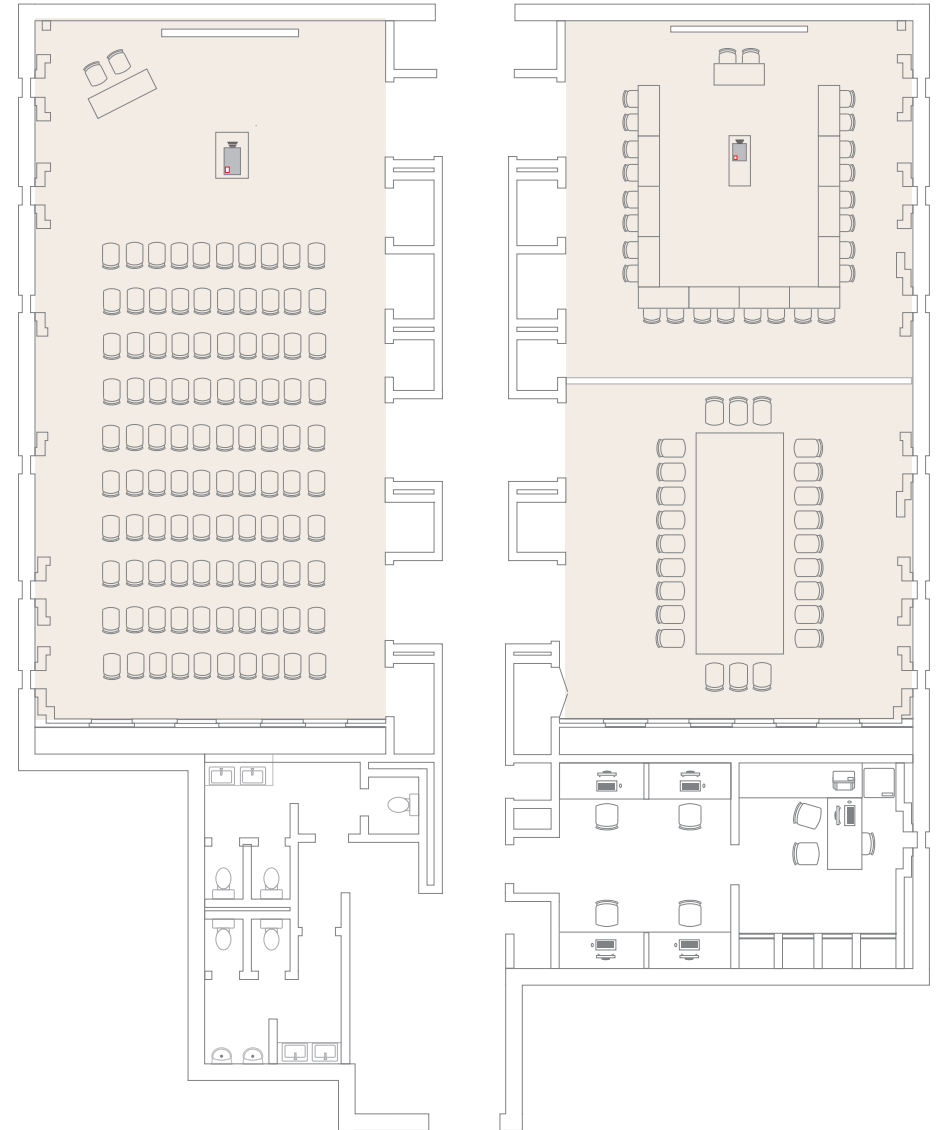

# ATLAS ROOMS

**Description:** Flexible conference and event facility with retractable walls that can be converted into different size rooms. Total of six conference rooms that can be partitioned into two large rooms or four conference rooms.

**Specials:** Adjacent to and on the same floor as the Aurora Ballroom. Retractable screen projector screen, air conditioning.

## Fully extended

**Area:** 123 m<sup>2</sup>  
**Length:** 16 m  
**Width:** 7.7 m  
**Height:** 2.6 m

## Central partition

**Area:** 59 – 63 m<sup>2</sup>  
**Length:** 7.7 – 8.1 m  
**Width:** 7.7 m  
**Height:** 2.6 m

## Partitioned into 6 separate rooms

**Area:** 37 - 43 m<sup>2</sup>  
**Length:** 4.8 – 5.7 m  
**Width:** 7.7 m  
**Height:** 2.6 m

**Lights:** Integrated ceiling lights with dimmer, feature wall lighting with colour settings.

**Daylight:** Feature marine windows with curtains or black out blinds

Set-ups:	Maximum capacity		
	Fully extended	Central partition	Separate rooms
<b>Theatre:</b>	100	50	30
<b>Class room:</b>	80	50	20
<b>U-shape:</b>	40	32	20
<b>Boardroom:</b>	48	24	10/16

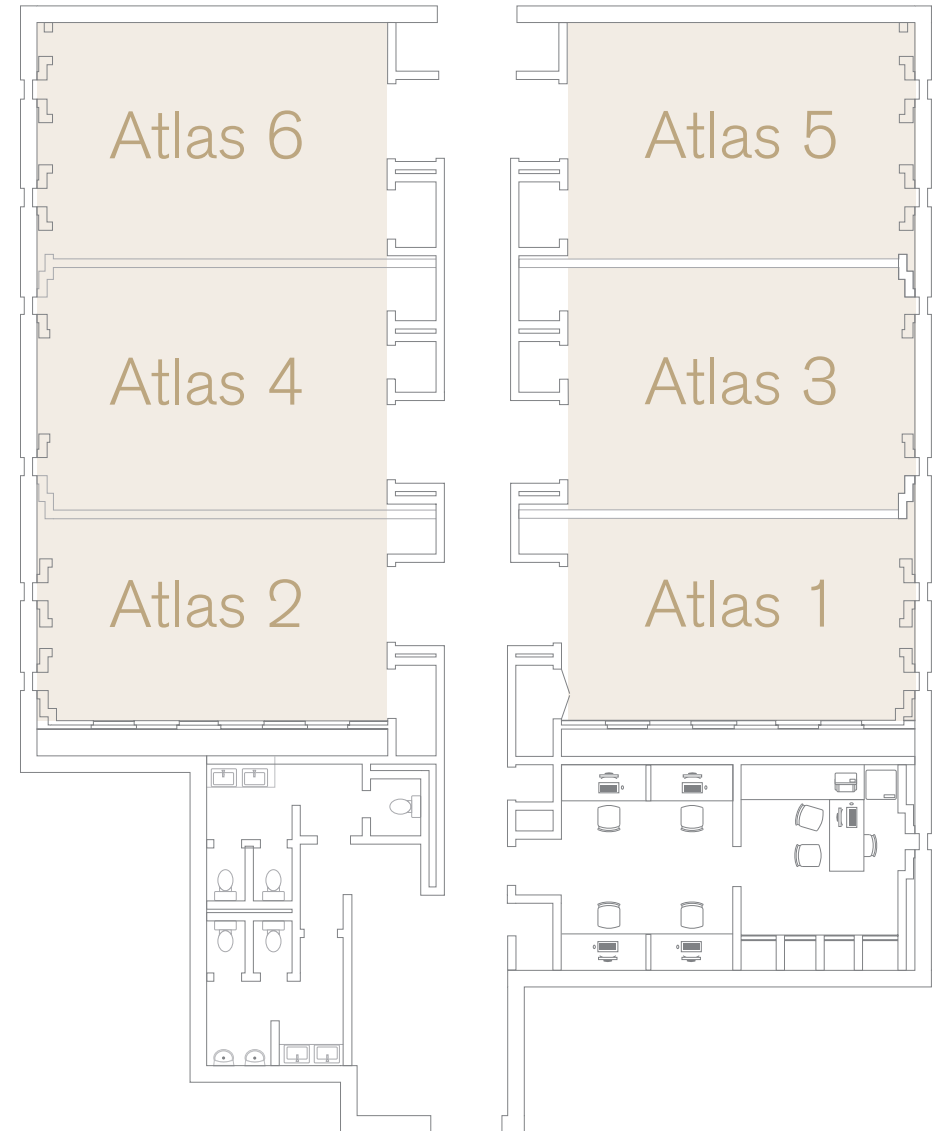

# ATLAS ROOMS

**Description:** Spacious function rooms with panelled walls and feature wall. Flexible event space that can be converted to different size function rooms.

**Specials:** Access via grand staircase from main reception. Retractable projector screen, air conditioning.

## Fully extended

**Area:** 123 m<sup>2</sup>  
**Length:** 16 m  
**Width:** 7.7 m  
**Height:** 2.6 m

## Central partition

**Area:** 59 – 63 m<sup>2</sup>  
**Length:** 7.7 – 8.1 m  
**Width:** 7.7 m  
**Height:** 2.6 m

## Partitioned into 6 separate rooms

**Area:** 37 - 43 m<sup>2</sup>  
**Length:** 4.8 – 5.7 m  
**Width:** 7.7 m  
**Height:** 2.6 m

**Lights:** Integrated ceiling lights with dimmer, feature wall lighting with colour settings.

**Daylight:** Feature marine windows. Curtains or black out blinds.

Set-ups:	Maximum capacity		
	Fully extended	Central partition	Separate rooms
Banquet	80	60	–
Banquet with dance floor	60	–	–
Cocktail party	100	50	30

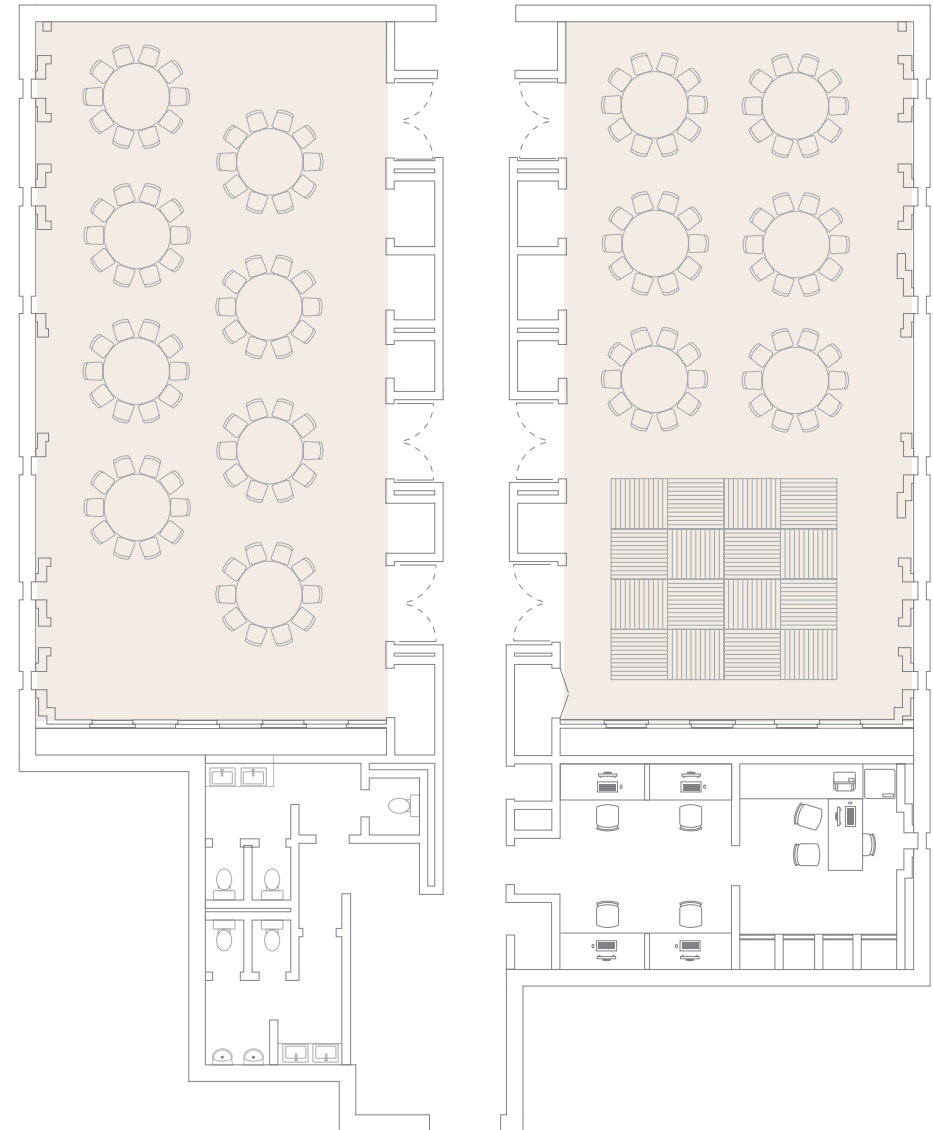

# ATLAS ROOMS

**Description:** Spacious function rooms with panelled walls and feature wall. Flexible event space that can be converted to different size function rooms.

**Specials:** Access via grand staircase from main reception. Retractable projector screen, air conditioning.

## Fully extended

**Area:** 123 m<sup>2</sup>  
**Length:** 16 m  
**Width:** 7.7 m  
**Height:** 2.6 m

## Central partition

**Area:** 59 – 63 m<sup>2</sup>  
**Length:** 7.7 – 8.1 m  
**Width:** 7.7 m  
**Height:** 2.6 m

## Partitioned into 6 separate rooms

**Area:** 37 - 43 m<sup>2</sup>  
**Length:** 4.8 – 5.7 m  
**Width:** 7.7 m  
**Height:** 2.6 m

**Lights:** Integrated ceiling lights with dimmer, feature wall lighting with colour settings.

**Daylight:** Feature marine windows. Curtains or black out blinds.

Set-ups:	Maximum capacity		
	Fully extended	Central partition	Separate rooms
Banquet	80	60	–
Banquet with dance floor	60	–	–
Cocktail party	100	50	30

